

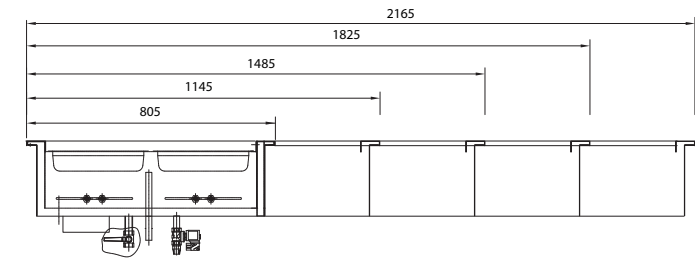

BM

- LSBM2
- LSBM3
- LSBM4
- LSBM5
- LSBM6

- Dual purpose used wet or dry
- Auto Fill - Wet elements
- Overhead halogen lights
- Full size pans 65mm deep supplied (max 100mm)

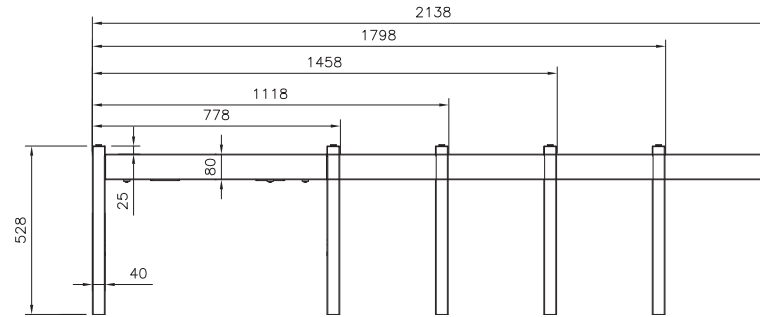
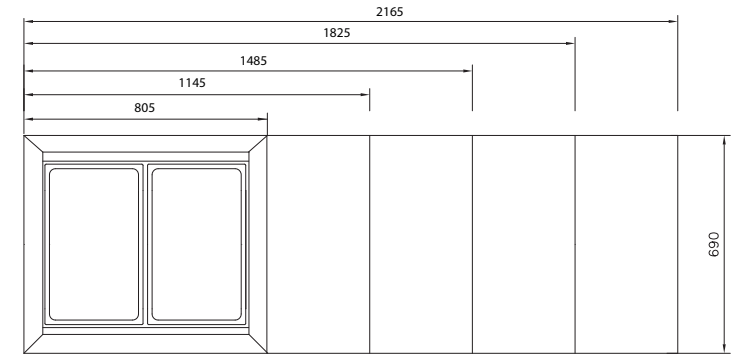
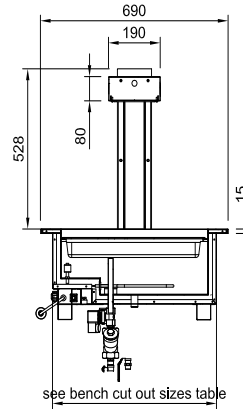

GANTRY SIZES

CABINET DIMENSIONS & SPECIFICATIONS

MODEL	CABINET			BENCH TOP CUT OUT HOLE SIZE	PANS	TEMP RANGE	W A T E R FILL LITERS	POWER CORD LENGTH	FREQUENCY	REFRIGERANT	OPERATING CURRENT	CONNECTION	VOLTAGE	PACKED FOR SHIPPING				
	LENGTH [MM]	DEPTH [MM]	HEIGHT [MM]											LENGTH [MM]	DEPTH [MM]	HEIGHT [MM]	WEIGHT [KG]	CUBE
LSBM2	805	690	555	780X635	2 X 1/1	75-85	39	3000MM	50/60 HZ	N/A	10 AMP	15 AMP LEAD ONLY	220-240V	910	770	670	66	0.469
LSBM3	1145	690	555	1120X635	3 X 1/1	75-85	57	3000MM	50/60 HZ	N/A	15 AMP	20 AMP LEAD ONLY	220-240V	1250	770	670	88	0.7219
LSBM4	1485	690	555	1460X635	4 x 1/1	75-85	75	3000MM	50/60 HZ	N/A	20 AMP	30 AMP LEAD ONLY	220-240V	1590	770	670	107	0.9182
LSBM5	1825	690	555	1800X635	5 x 1/1	75-85	93	3000MM	50/60 HZ	N/A	25 AMP	30 AMP LEAD ONLY	220-240V	1930	770	670	128	1.1146
LSBM6	2165	690	555	2140X635	6 x 1/1	75-85	113	3000MM	50/60 HZ	N/A	30 AMP	40 AMP LEAD ONLY	220-240V	2270	770	670	140	1.3109



GLFT Flat Top

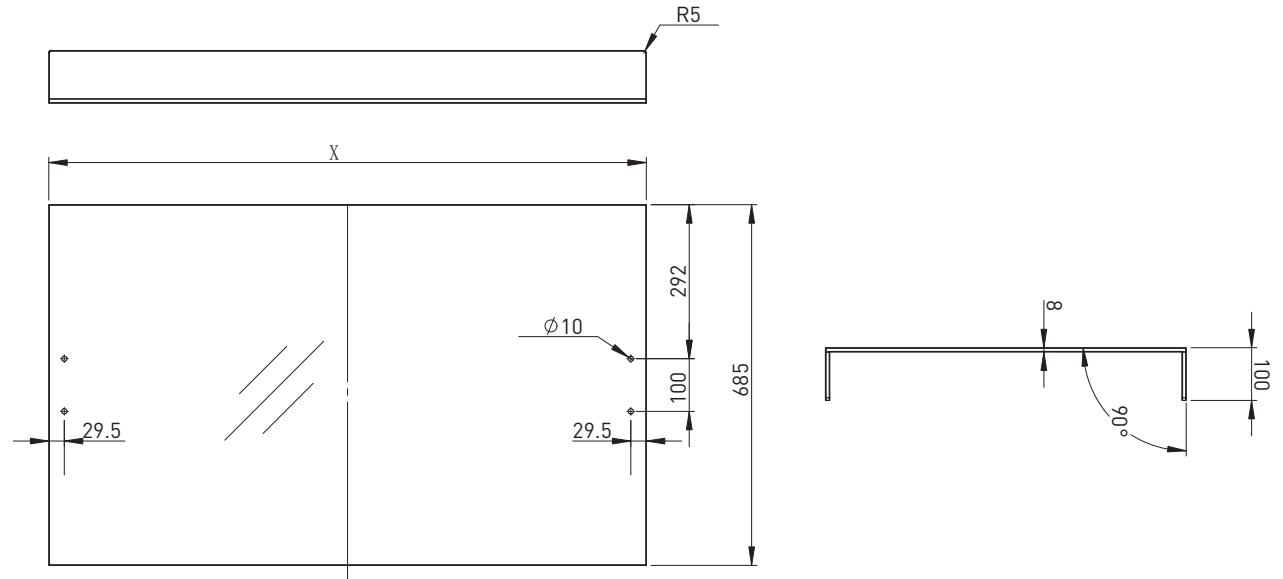

GLFS Full Square Glass

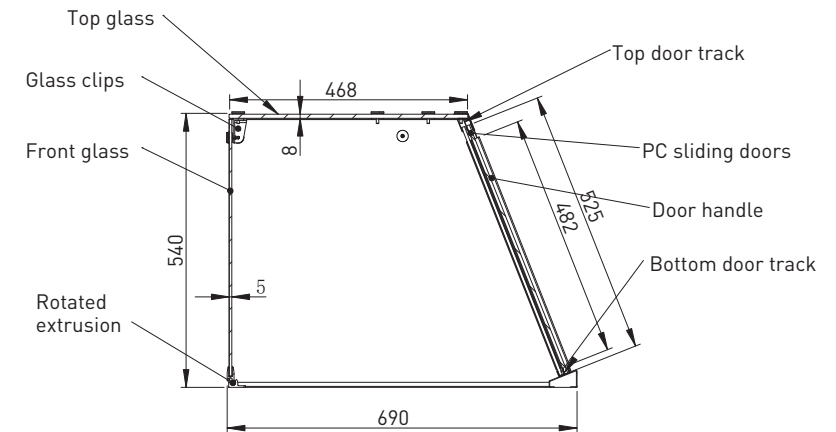
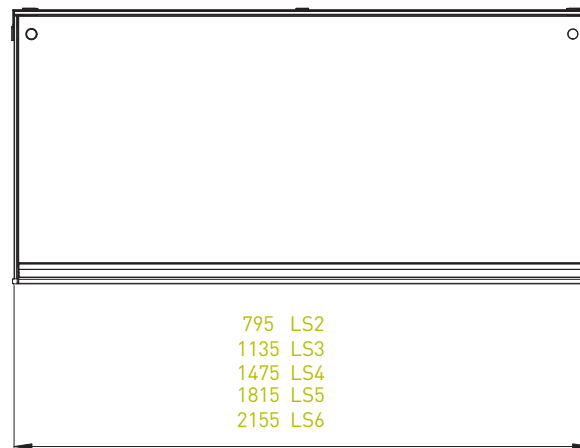

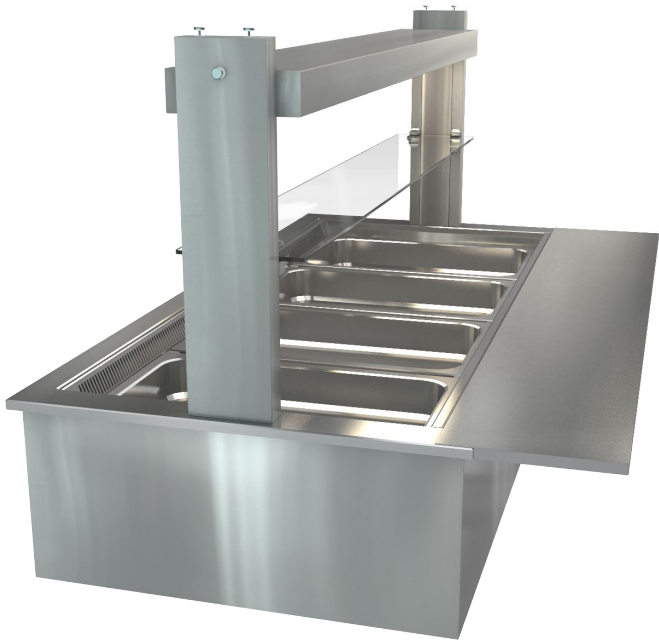

SHELF DIMENSIONS & SPECIFICATIONS

MODEL	CODE	TOTAL SHELF LENGTH	SHELF DEPTH
LS-2	X000612	800 MM	250 MM
LS-3	X000613	1140 MM	250 MM
LS-4	X000606	1480 MM	250 MM
LS-5	X000614	1820 MM	250 MM
LS-6	X000615	2160 MM	250 MM

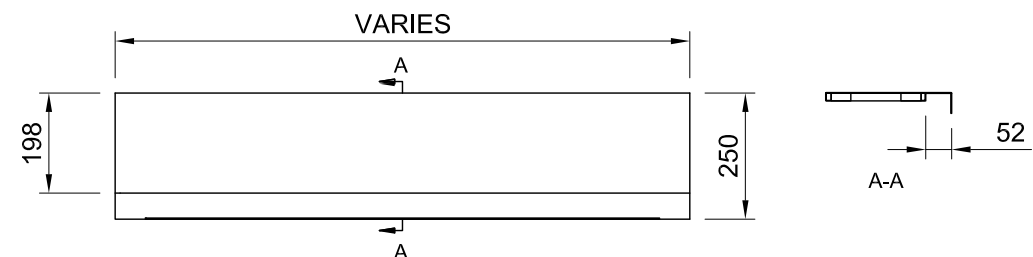



LSBM RISER

- Fitted to enable the use of 150mm deep gastro pans
- Available for all sizes LSBM3 - LSBM6
- Stainless steel construction
- Drops into existing units
- Sold as individual units
- Allows all or some of the pans to be 150mm deep



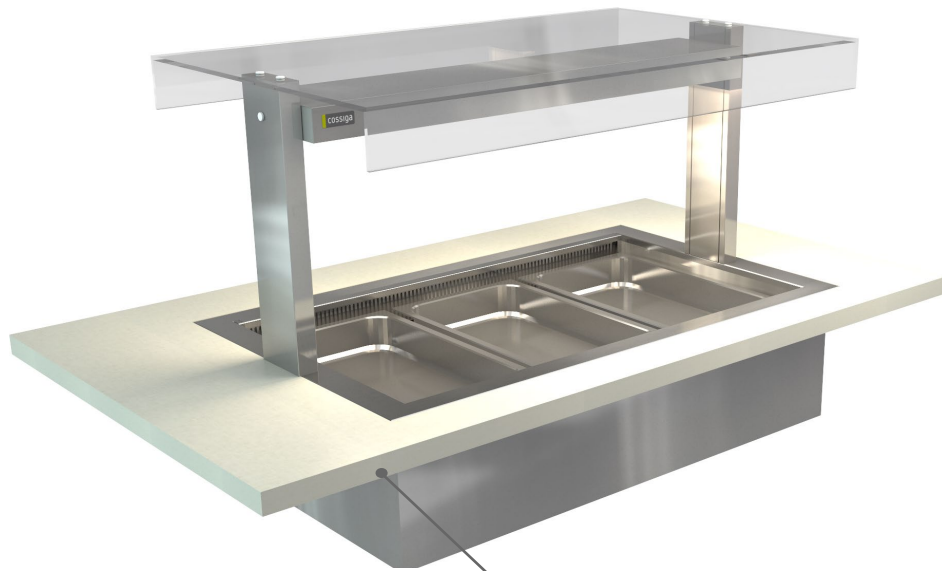

Additional support may be required under bench ie. stainless steel hollow section to frame

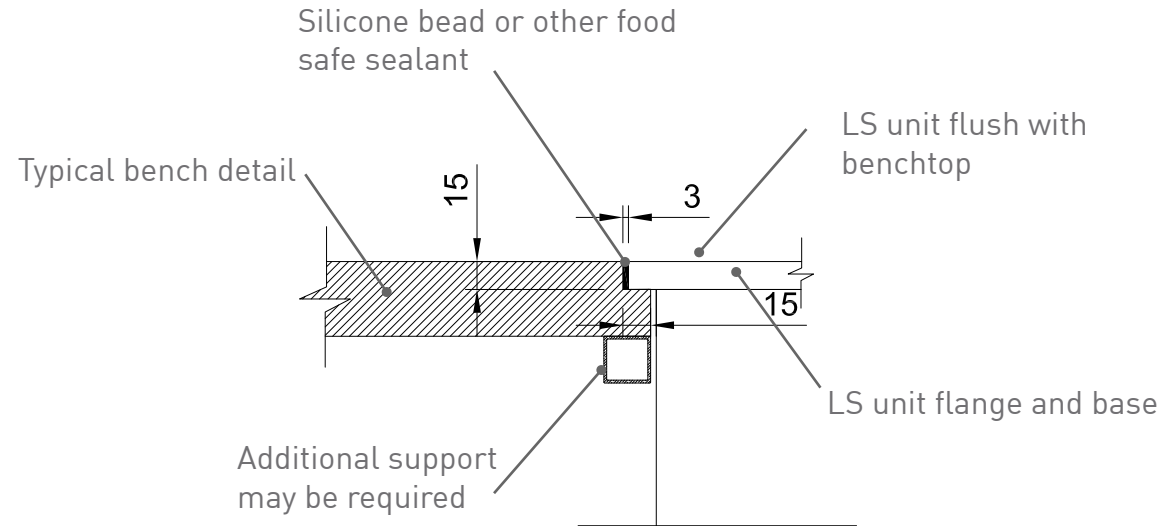

Counter top joinery must be of sufficient structural capacity to take the weight of the LS unit when the flange detail has been made.

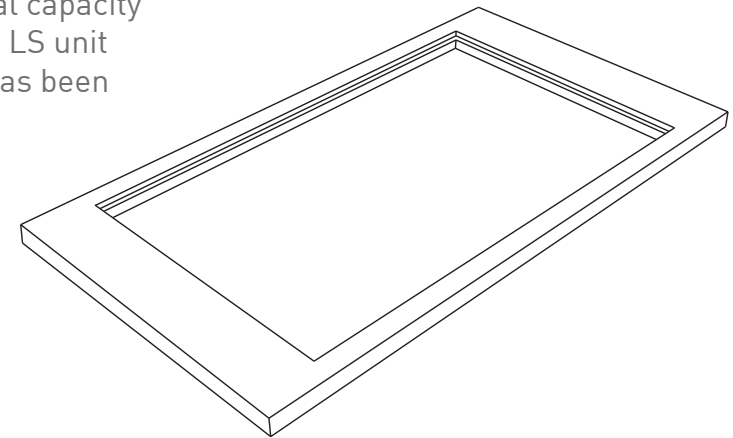

ELECTRICAL POWER

Electrical power cord 3000mm
1 phase connection required.
Unit must be hard wired on site
to isolation switch.

Overhead
300 Watt
halogen lights.
other wattages available
upon request

WATER DRAINAGE

Screw on stop cock valve drain pipe
Ideally drain connected to waste.
Overflow flexible waste pipe 19mm
dia.1000 mm length from valve must
be connected to waste.

Ensure sufficient
water in well to
activate the float
switch or heating
elements will
not turn on.

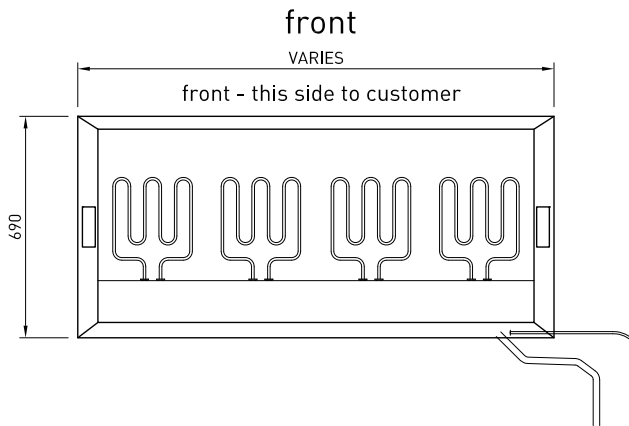
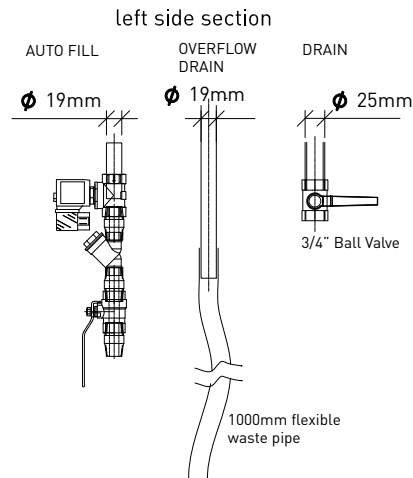
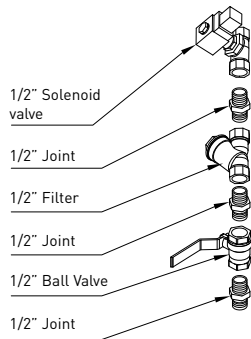

UNITS SUPPLIED
WITH 1/1 PANS
AT 65MM DEEP,
MAX PAN DEPTH
IS 100mm.
Riser accessory
available to allow
150mm pans

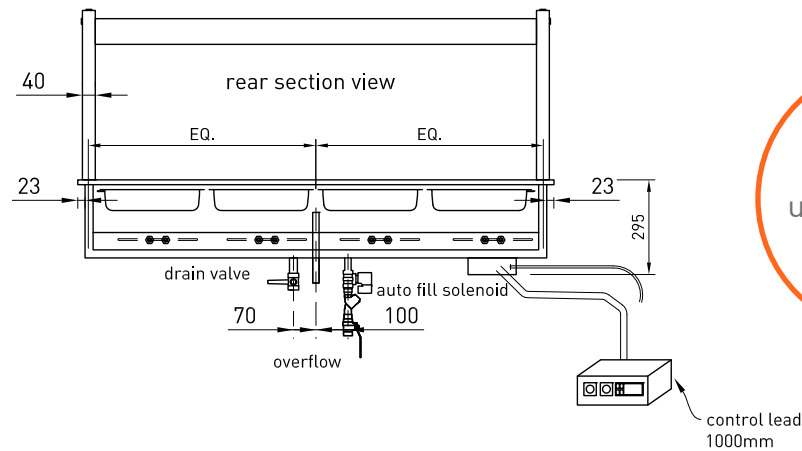

Dual purpose
used wet or dry

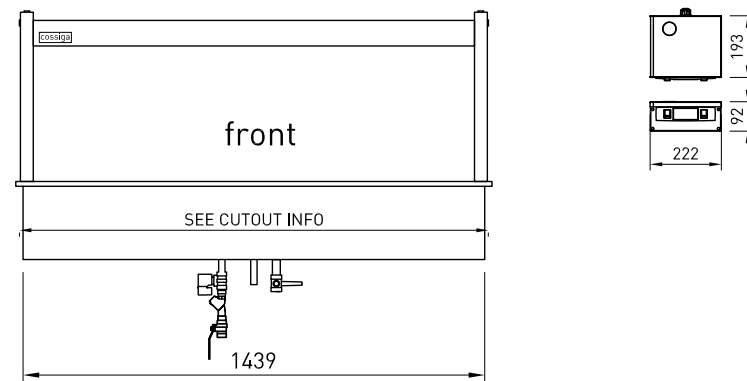

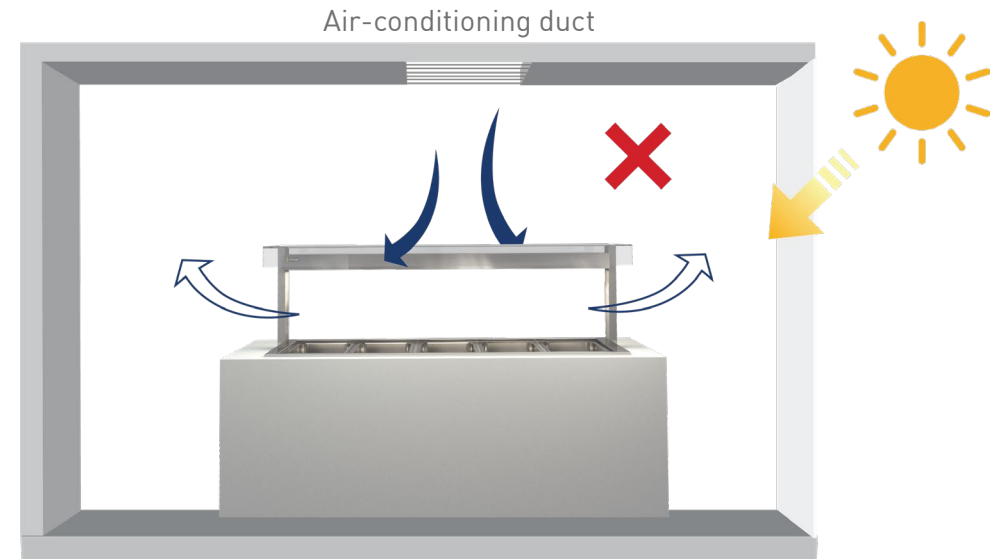
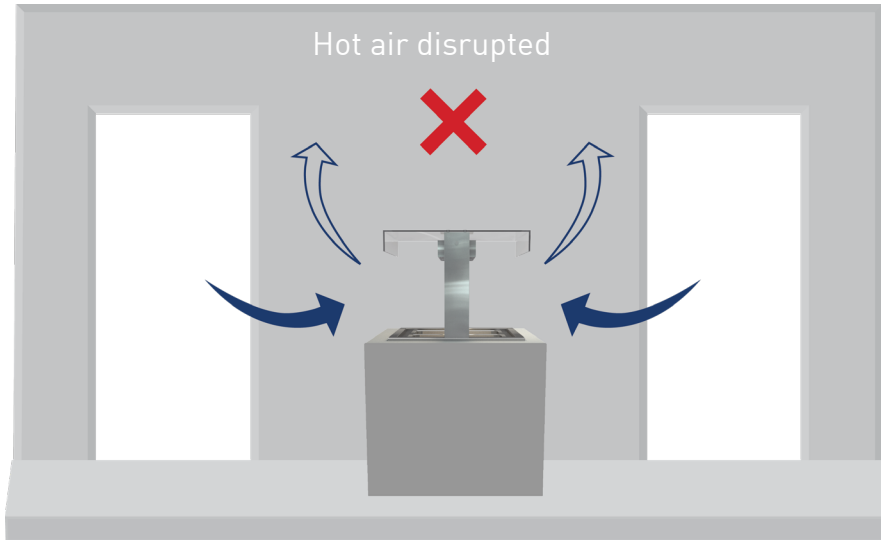

Locations to avoid

- Drafts from doorways
- Airflow from air-conditioning ducts
- Hot air from motors i.e. refrigerators
- Direct sunlight

Disrupted air flow

Heat from other equipment and natural conditions, such as direct sunlight straight on units, can cause cooling to fail and overload compressor

Mechanical air flows, such as diffusers and fans can disturb the air curtain on units causing failure

